

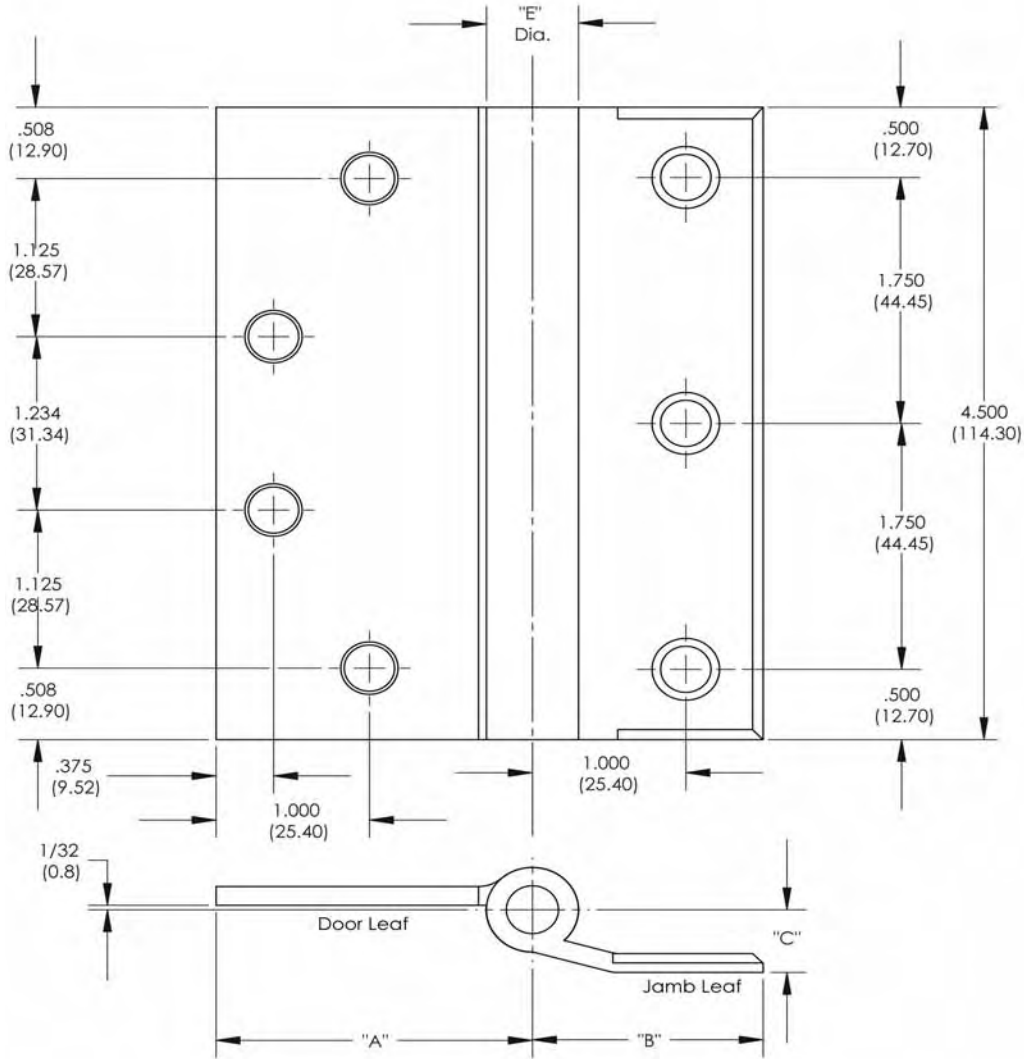

HALF MORTISE TEMPLATE

PB - CP - BB - CB - 4B - 4C
4-1/2"



Part Number			Gauge of Metal	"E" Outside Dia.	"A" To Center Line	"B" To Center Line	"C" Jamb Leaf Offset
Steel	Brass	Stainless					
PB82/CP82	PB22/CP22	PB52/CP52	.134"	.593"	2-1/16"	1-1/2"	7/16"
BB82/CB82	BB22/CB22	BB52/CB52	.134"	.593"	2-1/16"	1-1/2"	7/16"

NOTE:

- 1 screw pack includes all machine screws (7).
- Screw size: FHMS - 12-24 x 1/2"
OHMS - 12-24 x 1/2"
- All half mortise hinges are made for reversible applications.
- All hinges are ANSI template.

PBB, Inc.
World Class Hinges

1311 E. Philadelphia Street • Ontario • CA 91761 • USA
PBB reserves the right to make changes without notice.

Template: BB8245