

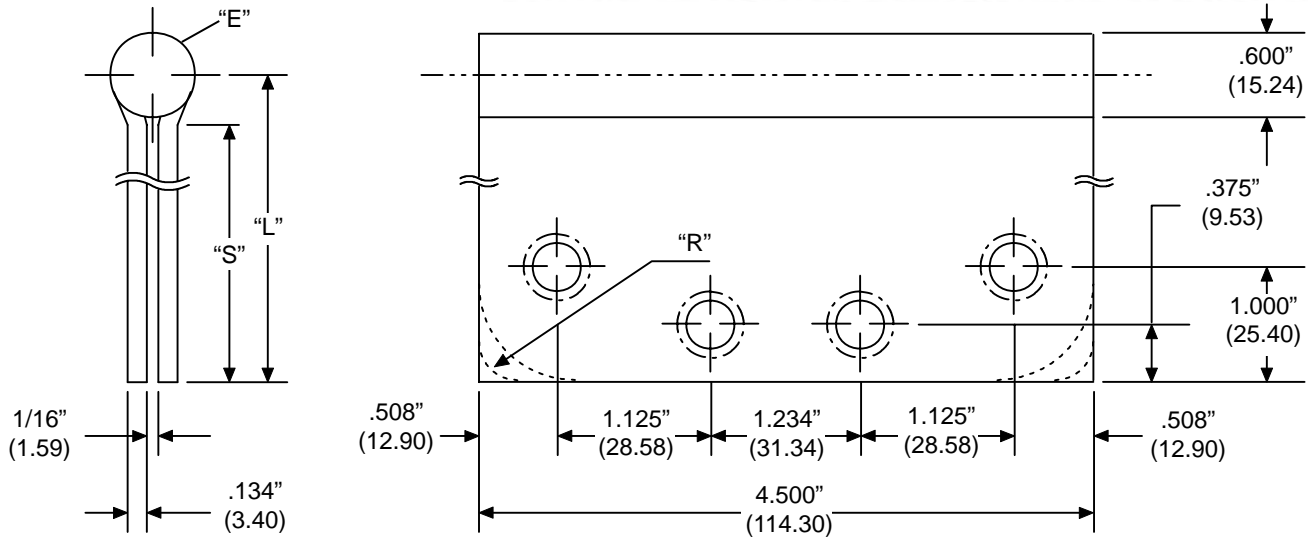

FULL MORTISE STANDARD WEIGHT TEMPLATE

WTBB - WTPB - WTCB - WTCP - WTFB
4-1/2" x 5", 4-1/2" x 6", 4-1/2" x 7", 4-1/2" x 8"



Part Number			Gauge of Metal	"E" Outside Dia.	"L" Leaf Width	"S" Swage Line	"R" Corner Radius
Steel	Brass	Stainless					
WTBB81/ WTPB81	WTBB21/ WTPB21	WTBB51/ WTPB51	.134"	.600"	2.50"	2.13"	Square, 1/4", 5/8"
WTBB81/ WTPB81	WTBB21/ WTPB21	WTBB51/ WTPB51	.134"	.600"	3.00"	2.63"	Square, 1/4", 5/8"
WTBB81/ WTPB81	WTBB21/ WTPB21	WTBB51/ WTPB51	.134"	.600"	3.50"	3.13"	Square, 1/4", 5/8"
WTBB81/ WTPB81	WTBB21/ WTPB21	WTBB51/ WTPB51	.134"	.600"	4.00"	3.63"	Square, 1/4", 5/8"

NOTE:

- 1 screw pack includes all machine screws (24), and 1/2 wood screws (12). ATMS & AWS also available.
- Screw size: FHMS - 12-24 x 1/2"
FHWS - 12 x 1-1/4"
- All hinges are ANSI template.